

Workshop is farther from Main House than shown

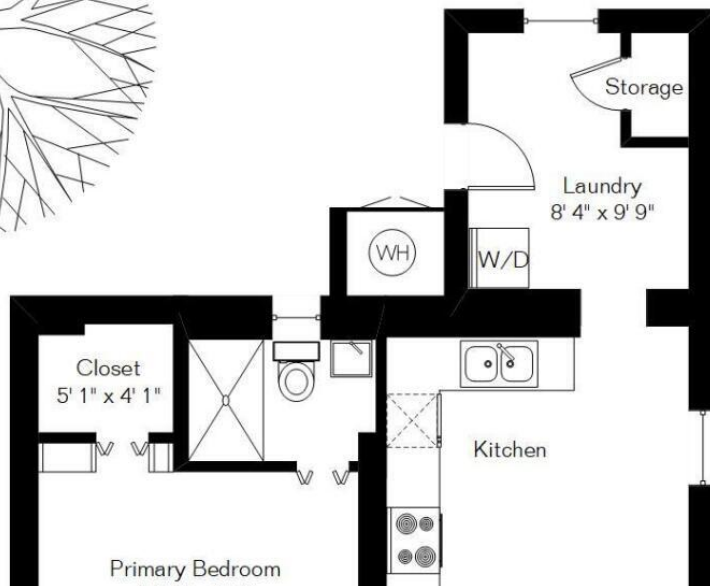

Workshop



**\$325,000**

## 1334 W EMERY ST, TUCSON, AZ 85745, USA

<https://rehomes.us>

Remodeled 1bed/1.5bath bungalow in historic Menlo Park. This cute home features high ceilings, partially exposed adobe brick, gorgeous concrete floors, new S/S appliances, updated windows and HVAC. New plumbing complete with soft water system. Zoned R2 with an additional workshop/artist studio in the rear of the property complete with mini-splits and half bath. So much [...]

- 1 bed
- 2.00 baths
- Single Family Residence
- Residential
- Active



**William Moyer**

## Basics



**Category:** Residential

**Status:** Active

**Bathrooms:** 2.00 baths

**Year built:** 1948

**Days On Market:** 1

**County:** Pima

**Lot Acres:** 0.16 acres

**Lot Dimensions:** Irregular

**View:** Mountains

**Type:** Single Family Residence

**Bedrooms:** 1 bed

**Lot size:** 6970.00 sq ft

**MLS #:** 22322958

**Bathrooms Full:** 1

**List Number Main:** 22322958

**Municipality/Zoning:** Tucson - R2

**Township:** 14

Description

**Legal Description:** W50' Of E206.67' Of S150' Of That Pt Of L 22 N Of Cen Line Of Emery St & W Of Cen Line Of Westmoreland S .16 Ac P 99-11

Rooms

**Sauna Level:** TUSD

**Kitchen Features: Appliance Color:** Stainless

**Extra Room:** Office,Storage,Studio,Workshop

**Kitchen Features: Countertops:** Quartz

**Dining Areas:** Dining Area

**Kitchen Features:** Garbage Disposal,Gas Cooktop,Gas Oven,Microwave,Refrigerator,Water Purifier

Building Details



**Lot Features:** Cul-De-Sac  
**# of Carport Spaces:** 0.00  
**Basement:** No  
**Construction:** Masonry Stucco,Mud Adobe,Stucco Finish  
**# of Garage Spaces:** 0.00  
**Style:** Bungalow  
**Construction Status:** Existing

**Garage/Carport Feat:** None  
**Floor covering:** Concrete  
**Fence: Other:** Metal  
**Main House SqFt:** 723.00 sq ft  
**Stories:** One  
**Fence:** Block,View Fence

---

## Miscellaneous

**Compensation Disclaimer:** The listing broker's offer of compensation is made only to participants of the MLS where the listing is filed.

**Subdivision Name:** N/A

**Landscape - Front: Other:** Desert Plantings,Natural Desert,Trees

**Horse Property:** No

**Guest House SqFt:** 243.0000

**Landscape - Rear: Other:** Artificial Turf,Desert Plantings,Natural Desert,Trees

**Subdivision Restrict: Deed Restrictions:** No

**Association & Fees: HOA:** No

**Accessibility Option:** None

**Assessments:** \$0

**Community:** None

**Tax Code:** 116-18-361A

**Property Disclosures:** Insurance Claims History Report,Seller Prop Disclosure

**Road Maintenance:** City

**Terms:** Cash,Conventional,FHA,Submit,VA

**Special Listing Conditions:** None

**Co-op Fee:** \$3

**Direction:** W

**Horse Facilities:** No

**Electric: Electric Company:** TEP

**Driveway: Paved:** Gravel

**Subdivision Restrict: Age Restrictions:** No

**Home Protection: Offered:** No

**Driveway:** Car(s) Pad

**Section:** 11

**Fire Protection:** Included in Taxes

**Range:** 13.00

**Road Type:** Paved

**Technology:** Built-Up, High Speed Internet,Smart Thermostat



---

## Listing Office

**ListingOfficeName:** Tierra Antigua Realty

**Listing Office Address:** 216 E. Congress,  
Tucson, AZ 85701

**Listing Member Phone:** (860) 449-4381

**Listing Office Phone:** (520) 428-3338

**Listing Office Url:**  
<https://www.tierraantigua.com/>

---

## Units Information

**Unit Level:** 1

---

## Amenities & Features

**Interior Features:** Ceiling Fan(s),Dual  
Pane Windows,Walk In Closet(s),Water  
Purifier,Water Softener,Workshop

**Sewer:** Connected

**Primary Bathroom Features:** Exhaust  
Fan,Pedestal Sink(s),Shower Only

**Pool: Conventional:** No

**Fireplace:** None

**Main Heating:** Gas Pac

**Pool:** None

**Spa:** None, None

**Water Heater:** Natural Gas

**Gas:** Natural

**Exterior Features:** Native Plants,Rain  
Barrel/Cistern(s),Workshop

**Neighborhood Feature:** None

**Fireplace Location: Other:** None

**Laundry:** Laundry Room,Stacked Space

**Main Cooling:** Central Air

**Patio/Deck:** Patio,Paver

**Security:** Cameras,Carbon Monoxide  
Detectors,Security Lights,Smoke Detector(s)

**Water:** City

**Window Covering:** Stay

**Guest Facilities:** None

---

## Nearby Schools

**High School:** Cholla

**Elementary School:** Maxwell K-8

**Middle School:** Safford K-8 Magnet





# Fees and Taxes

Tax Year: 2023

